

THIS DOCUMENT CONTAINS PROPRIETARY DATA OF POLARIS INDUSTRIAL ENTERPRISES, INC. NO DISCLOSURE, REPRODUCTION, OR USE OF ANY PART THERE OF MAY BE MADE EXCEPT BY WRITTEN PERMISSION.

REV.	BY	DATE	APPRVD.
C	AT	10-23-01	

P/N	SP22GS
REVISED OPTIONS	

SPECIFICATIONS

ELECTRICAL

RESISTANCE RANGE-----500,1K,2K,5K,10K,20K,50K,100K
 RESISTANCE TOLERANCE-----±10%
 LINEARITY INDEPENDENT-----±1.0%
 POWER RATING _____ 1.0 WATTS
 ELECTRICAL ANGLE-----340°±4°
 END VOLTAGE _____ 0.2% MAX
 RESOLUTION-----ESSENTIALLY INFINITE
 OUTPUT SMOOTHNESS-----BELOW 0.1% AGAINST INPUT VOLTAGE
 CONTACT RESISTANCE VARIATION-----BELOW 2%
 INSULATION RESISTANCE-----1000MEGOHMS @ 500VDC MIN.
 DIELECTRIC STRENGTH-----500 VAC

MECHANICAL

MECHANICAL ANGLE _____ CONTINUOUS
 ROTATIONAL TORQUE _____ 0.7 OZ.IN.
 SHAFT END PLAY ----- .006MAX.
 TEMPERATURE COEFFICIENT-----±400 PPM/°C
 WEIGHT, APPROX. ----- 1.1 OZ.
 ROTATIONAL LIFE ----- 10,000,000 TURNS

ENVIRONMENTAL

OPERATING TEMPERATURE _____ -55°C TO +105°C
 TEMPERATURE COEFFICIENT _____ ±400 P.P.M/°C
 VIBRATION _____ 10HZ TO 2000HZ 15G
 SHOCK _____ 50G 11MS
 MOISTURE RESISTANCE _____ 40°C 95%RH 120 HOURS

MATERIALS

HOUSING -----HIGH TEMPERATURE PLASTIC
 TERMINALS-----SOLDERABLE DOUBLE TURRET
 SHAFT -----STAINLESS STEEL
 ELEMENT-----CONDUCTIVE PLASTIC

OPTIONS

FRONT SHAFT MODIFICATIONS
 CENTER TAP
 O'RING SHAFT SEAL
 SEALED BODY
 SPECIAL ELECTRICAL / MECHANICAL ANGLES
 SPECIAL LINEARITY & RESISTANCE TOLERANCES
 BUSHING MOUNT (SEE SP22G)

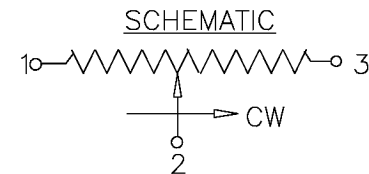
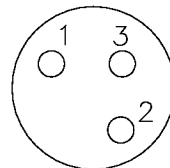
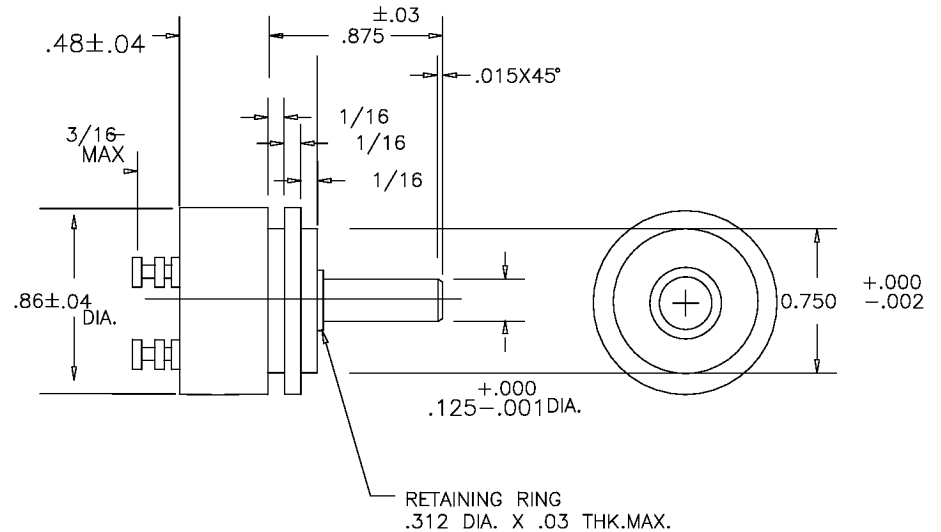

TOLERANCES
 XX = +/- .010" FRACT. = +/- 1/64"
 XXX = +/- .005" ANGLES = +/- 1/2"
 ALL SPECIFICATIONS SUBJECT TO CHANGE WITHOUT NOTICE.

SCALE	DATE:	7-05-01
	BY	
NONE	APPRVD	AT
	CODE IDENT:	19477

PRECISION SALES INC
 P:610-359-1002
 F:610-353-1674
www.precisionsales.com

TITLE
 SINGLE TURN
 POTENTIOMETER

PART NO.
 SP22GS